



presenting

m/s didi

Southern Cross Blue Cruising

When an Italian interior designer is let loose on a Turkish gulet, one knows that they will have created a new level of luxury and style.



At 24 meters length with four cabins taking up to 8 guests, Didi is a spectacular, contemporary gulet with impeccable service. There is a forward and an aft master, as well as a double and a twin stateroom, all with white marble en-suite bathrooms. The patented deck chairs, fine linens and modern approach to décor sets Didi apart from many other gulets as does her professional crew.



Southern Cross Blue Cruising



Southern Cross Blue Cruising



Forward Lounge



Sunbeds

Didi brings a very contemporary, modern feel to a Bodrum built gulet. She is the ultimate blend of the latest technology with traditional workmanship.



Southern Cross Blue Cruising

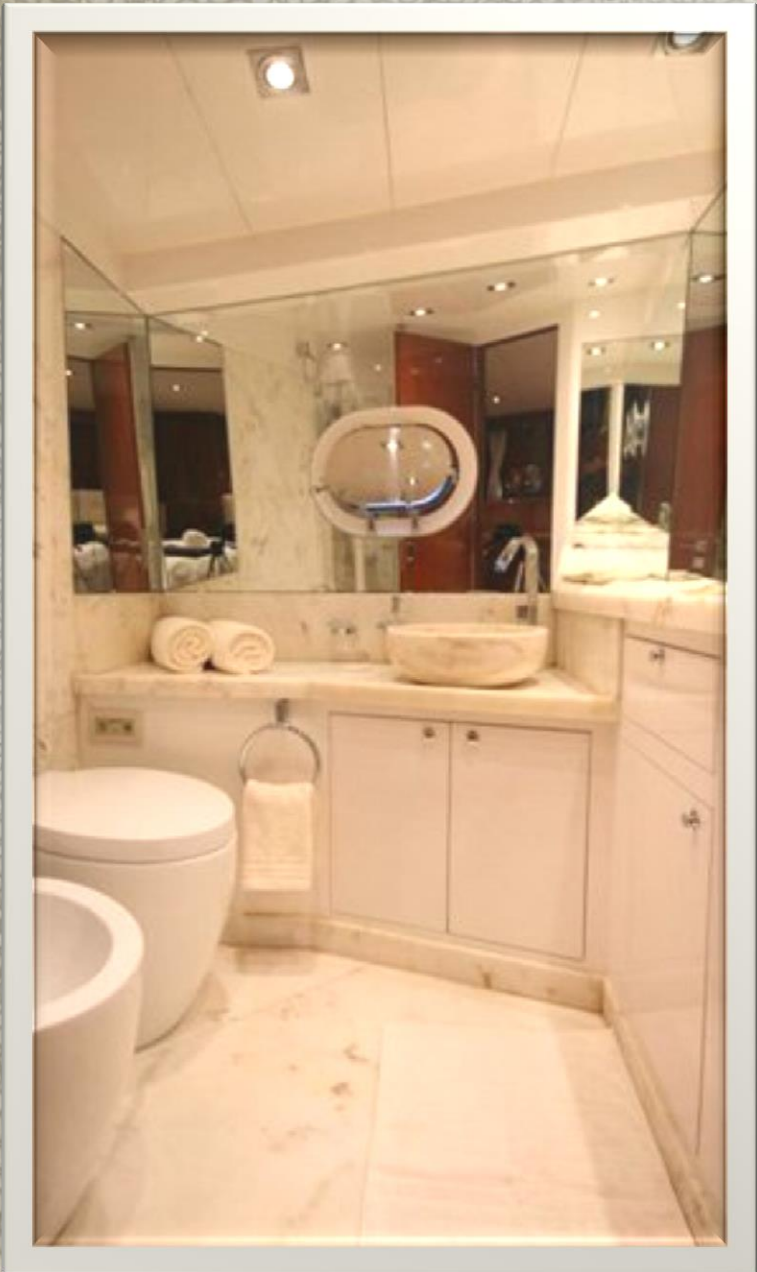

Southern Cross Blue Cruising

Didi Layout & Accommodation

Forward Master

Forward Double

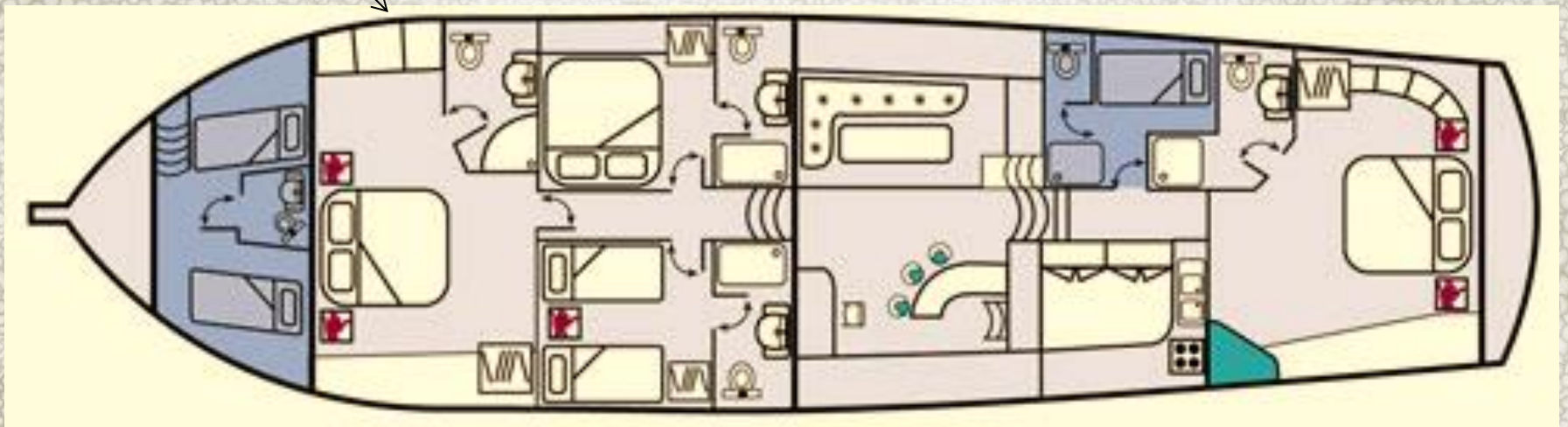

Forward Twin

Aft Master

Southern Cross Blue Cruising

Didi Technical Details

Year of construction	2010
LOA	24,00m
Beam	6,50m
Engine	2 x 280 hp Fiat Iveco
Generator	2 x 22,5 KW Onan
Electricity	220 24V
Water maker	220 tl per hour
Water capacity	4 ton
Fuel capacity	4 ton
Autopilot	
VHF	
GPS	
Deep Sounder	
Radar	
AIS system	
Fishfinder	
Crew:	Four
Water sports:	ringo, water ski, canoes, snorkeling equipment

Didi Amenities

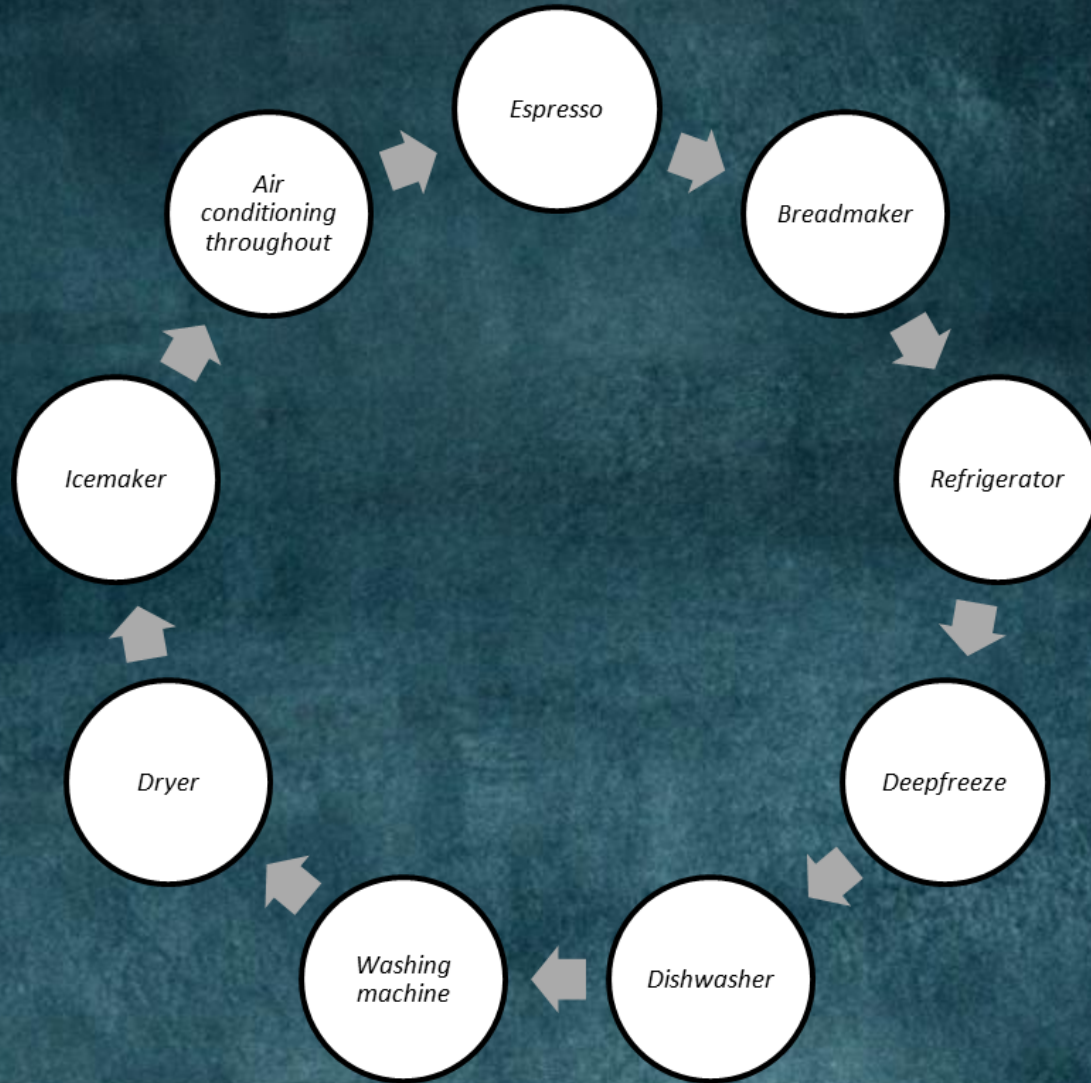



Southern Cross Blue Cruising