

M/S AEGEAN CLIPPER

Price	★★★
Accommodation	Twelve cabins. Eight are twin and four are double for up to 24 people. All have A/C and en-suite bathrooms. Max suggested pax is 20.
Special Features	One of the few gulets qualified to take more than 12 pax to Greek Islands. Owner-captain and son very hospitable. Traditional fly bridge and three levels of outdoor seating.
Crew	4+1
Cruising Grounds	Turkey and Greek Dodecanese Islands

Technical Specifications

LOA	33 m
Beam	7.80 m
Draft	2.6 m
Hull Material	Mahogany plank on frame
Classification	Traditional Bodrum transom stern gulet
Sail Area	690 sq. m
Rigging	ketch
Fuel Capacity	4000 l
Water Capacity	7 tons
Speed	10 knots
Engine	550 Caterpillar
Construction	1999 Bodrum

Equipment

GSM telephone, radio-cassette, CD player, TV, Fax, Life extinguisher, dinghy with outboard 15 HP, 50 hp Zodiac speed boat, windsurf, 2 canoe, snorkeling equipment, fishing equipment, 2 deep freezer, ice maker, sun mattresses, sun awnings, outdoor shower, bar facilities

Af deck with seating facilities and table for dinner, Foredeck again with seating facilities and dining table There is an additional fly bridge with remote control and sun bathing facilities. Every cabin is supplied with soap, shampoo, face and body towels for the comfort of passengers.



For more information contact Mariner Boating Holidays
phone (02) 9966 1244 fax (02) 9966 1255 o
email info@marinerboating.com.au or website www.marinerboating.com.au

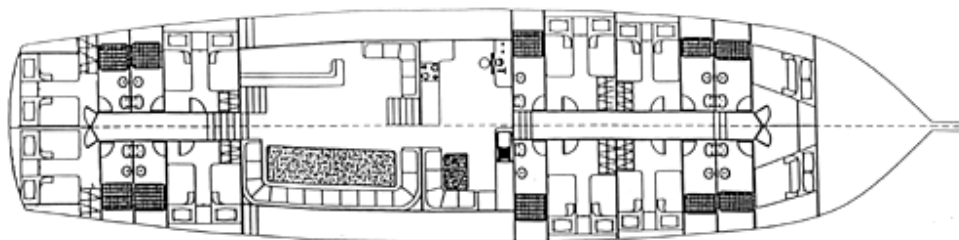

For more information contact Mariner Boating Holidays
phone (02) 9966 1244 fax (02) 9966 1255 o
email info@marinerboating.com.au or website www.marinerboating.com.au