

M/S Queen of Karia

QUEEN OF KARIA IS A LUXURIOUS MOTOR-SAILOR OF 35 METRES LOD THAT COMBINES THE VERY LATEST TECHNOLOGY WITH GLAMOUR, COMFORT AND CLASSIC STYLE.

HER CRUISING SPEED OF TWELVE KNOTS AND EXCELLENT HANDLING AT SEA ENSURE THAT LONG PASSAGES ARE UNDERTAKEN IN ABSOLUTE COMFORT, ALLOWING ONE TO ENJOY THE SAILING AND DISCOVER THE CHARM OF THE TURKISH COAST AND GREEK DODECANESE ISLANDS.

THIS IS A MOST SEAWORTHY VESSEL, BUILT WITH THE CARE AND PRIDE THAT ONLY THE FINEST CRAFTSMEN BRING TO EVERY DETAIL. SHE IS A GUARANTEE OF THE BEST VACATIONS, DREAM HOLIDAYS FOR THOSE WHO BELIEVE IN EXCELLENCE.



THE SPACIOUS AND LUXURIOUS LIVING AREAS, ENDOWED WITH EVERY IMAGINABLE COMFORT, ALLOW SAILING TO BE ENJOYED AS IF IN THE COMFORT OF ONE'S OWN HOME. THE INTERIORS HAVE BEEN FITTED IN PRECIOUS MAHOGANY WOOD OF THE VERY HIGHEST QUALITY.

THERE ARE FIVE SUITES IN TOTAL, INCLUDING AN AFT MASTER, FORWARD VIP, TWO TWINS AND ONE DOUBLE. EACH IS ENDOWED WITH MUSIC CENTRE AND FLAT-SCREEN TV, EACH WITH ITS EN-SUITE BATHROOM WITH HYDRO-MASSAGE SHOWER, AND ALL LIVING AREAS ARE EQUIPPED WITH INDIVIDUALLY CONTROLLED AIR-CONDITIONING.

THERE ARE THREE OTHER DISCRETE CABINS TO HOUSE THE CREW, COMPOSED OF THE CAPTAIN, COOK, HOSTESS AND THREE DECK-HANDS, ENSURING THE FINEST SERVICE ABOARD.

M/S Queen of Karia



Aft Master



Twin Stateroom



Double Stateroom



Forward VIP

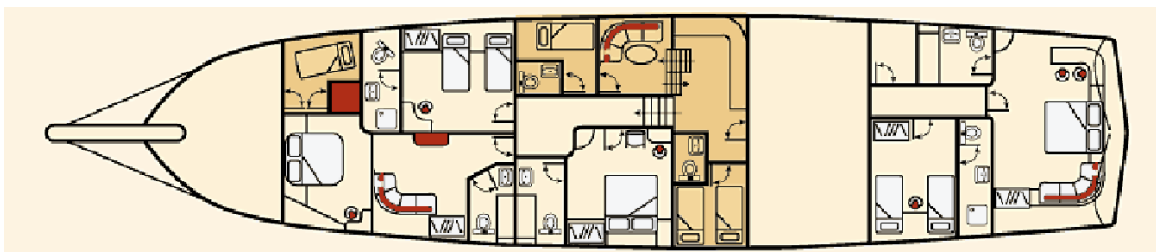
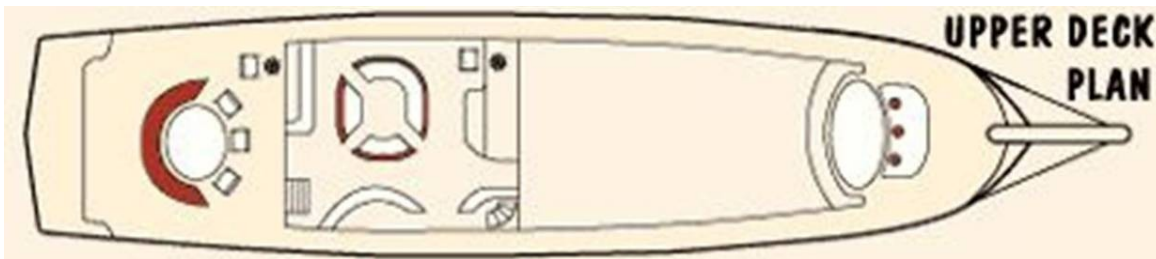

M/S Queen of Karia

Technical Specifications

QUEEN OF KARIA GENERAL SPECIFICATIONS	
YEAR OF CONSTRUCTION/REFIT	2004/2007
LOD	35 m
BEAM	8 m
DRAFT	3.25 m
ENGINES	2 x 440 HP MAN
RANGE UNDER POWER	Approximately 800 miles
FULL SPEED	15 knots
CRUISING SPEED	12 knots
SAIL AREA	800 m²
CABINS	Total 5: Aft master, forward VIP, double, 2 twin
Crew	Total 6: Captain, Engineer, Chef, 2 deckhands, hostess

FOR AN UNRIVALLED CHARTER EXPERIENCE ABOARD **Queen of Karia** IN THE EASTERN AEGEAN AND GREEK DODECANESE ISLANDS, PLEASE CONTACT YOUR YACHT CHARTER BROKER FOR AVAILABILITY AND PRICING.