



Southern Cross Blue Cruising
introducing...

Why Not?

contemporary 24 meter
wooden gulet based in
Turkey and Greece



Why Not is air conditioned throughout

Why Not has two master, one double and one twin stateroom for up to 8 guests.



Captain Emrah



Chef Mehmet



Senior
Deckhand
'The Fatih'



Deckhand Hussein

Why Not?

Master Staterooms

● Aft



● Forward



Southern Cross Blue Cruising

Why Not?

Guest Staterooms

• Double



• Twin



Southern Cross Blue Cruising

Why Not?

Contemporary Details



Southern Cross Blue Cruising

Type: Ketch-Gulet
Date of launching: 30th. May ,2008
Place of Built: Bodrum, Turkey
Flag: Malta
Construction: Epoxy Laminate
Classification: Rina/CE

TECHNICAL DATA

LOA: 24 m.
Beam: 6,30 m.
Draft: 2,80 m.
Engine: 2 x 235 hp Volvo Penta
Consumption 25 lt/hour each
Generator Onan 22,5 Kwa + 17,5 Kwa
Water Tanks 5500 Lt.
Fuel Tanks 3,000 Lt.
Sail Area 275 sqm.
Max Speed 12 Knots.

EQUIPMENT

Full Navigation equipment - Radar, GPS,
Depth sounder - Navtex - Autopilot - VHF
Water maker - Bow thruster - LCD TV - Satellite - DVD
Refrigerator - Deep freeze - Ice maker
Dish washer
220 V electrical supply.
Full bar facility.
Easy access swim ladder. Deck shower
Life raft for 12 people
Fishing tackle - Snorkeling equipment
Speed boat with 50 hp engine

Technical Specifications

Why Not?

ACCOMMODATION

4 guest suites comprising of:
2 master cabins with king sized double bed.
1 double and 1 cabin with twin beds.

All cabins have en-suite hydro-massage shower, individual remote controlled air-conditioning (hot-cold), push flush toilets, hair dryers, mini bar, fire extinguishers and smoke detectors. Air-conditioned inner saloon. Spacious sun deck with forward seating area. Separate crew quarters

Why Not?

Layout & Plan

Aft Master

Forward Twin

Forward Master

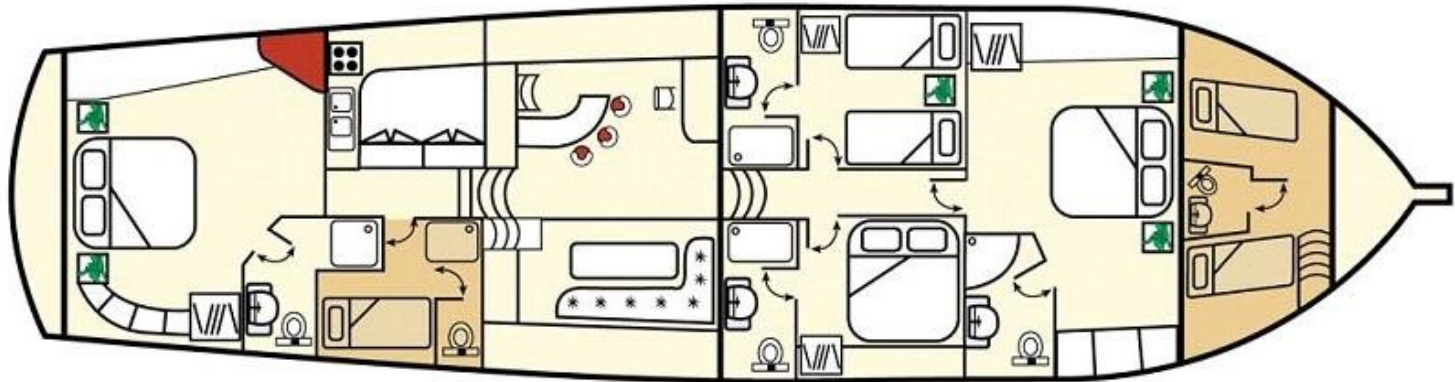

Forward Double

Why Not?



Southern Cross Blue Cruising