

Aegean Clipper

THE PERFECT GULET FOR LARGE GROUPS AND GREEK ISLANDS



This grand schooner is one of the very few in Turkey and Greece which offers excellent service to groups of up to 24 persons in 12 cabins. She is ideal for family reunions, weddings, and special interest groups.

Sailing

Ergun Captain, being mindful of both accounting and the environment, thoroughly enjoys sailing at every opportunity, and sailors will be delighted with the crew's energy and ability to maneuver this beautiful vessel.

Greek Islands

Aegean Clipper is one of the few gulets authorized to take groups of more than 12 to the Dodecanese Greek Islands.

Deck Space

The flybridge is unique to Aegean Clipper and there are three separate dining areas on board, as well as in the saloon. The separate galley

Ergun Captain speaks fluent German, English and moderate Greek and excels at performing marriage ceremonies.



At a Glance

Layout: Twelve cabins. Eight are twin and four are double for up to 24 people. All have A/C and en-suite bathrooms.

Crew: Five

LOA: 33 meters

Engine: 550 Caterpillar

Sail Area: 690 square meters

Fuel: 4000 liters

Water: 7000 liters

RIB: 15 HP and 50 HP

Equipment: TV, DVD, Fax, fire extinguishers, windsurf, 2 canoe, snorkeling equipment, fishing equipment, 2 deep freezers, ice maker, sun mattresses, sun awnings, outdoor shower, bar facilities

Build: 2000 Bodrum

Aegean Clipper

THE PERFECT GULET FOR LARGE GROUPS AND GREEK ISLANDS



Every cabin is supplied with soap, shampoo, face and body towels for the comfort of passengers.

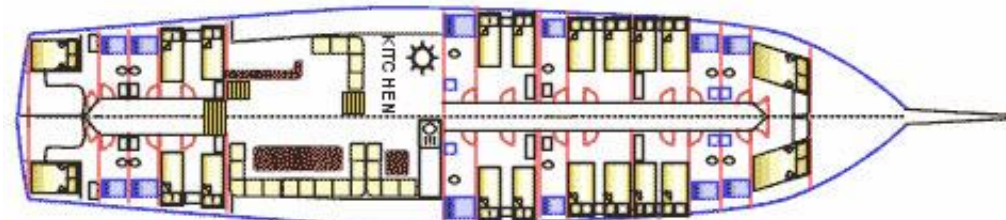

Prices include:

- An average of 4 hours per motor cruising per day over the duration of the cruise
- Welcome briefing, crew introduction, and itinerary/weather review
- Turkish port and harbor formalities in municipal ports
- Hire of crew, yacht, fuel, water, insurance, and local taxes
- Yacht laundry
- Use of yacht toys (water sports, snorkeling, fins, canoe, fishing equipment)

Prices do not include:

- Airport transfers (except for all-inclusive charters)
- Full board and drinks (except for all-inclusive yachts)
- Land excursions and museum entry fees
- Greek island customs, port and harbor fees
- Fuel for additional distances in excess of 4 hours per day
- Fuel for on-board toys
- Cancellation insurance
- Private Turkish marina fees
- Spirits, import wines and specialty drinks. These can be brought on board by client, or ordered in advance.
- Water sports (3rd party water skiing, jet skiing, scuba diving)
- Fuel for on-board toys
- Crew gratuity