

Clear Eyes

WORLD CRUISING ON A ABS CERTIFIED BODRUM SAILING GULET



The only sailing gulet in Bodrum built to both ABS and MCA standards.



Contemporary, modern sailing yacht in steel

The extensive exterior areas, conceived for life in the open air, are fully clad in teak, and their scale testifies to just how enjoyable the yacht is for cruising. That said, the most surprising feature is the spaciousness of the interior areas for long stays on board. These areas are fully clad in mahogany and confirm how comfortable the yacht is for longer voyages.

2010 Launch by Pax Navi Boatyard

State of the art technology has been used to ensure the quietest and smoothest of motor sailing conditions, including an independent suspension of the interior from the steel hull.

Flexible Accommodations

The master stateroom has a king-size bed and has his and her bathrooms. One twin cabin has an extra bed and one double cabin has an extra bed. The two forward double cabins, each with en-suite shower room, are convertible into one large stateroom. Crew of 8 have separate accommodations.



At a Glance

Accommodation: 1 Master, 3 double, 1 twin, and 2 pullman bunks

L.O.A: 43 M

Cabins: 5

Guests: 10

Crusing Speed: 10 knots/hour

Crew: 8

Beam: 29,6 FT / 9 M

Fuel Consumption: 100 ltr/hr

Engine: 2 x 670 hp CAT C18

Year of build: Pax Navi Yachts 2010

6.4m Northstar with 225hp Mercury

3.5m AB with 20hp outboard

2m Quicksilver with 6hp outboard

Jetski Seadoo RXP 250hp, 2 seater

Sea Bob 5hp (diving up to 40 meters)

Laser Dinghy Pico. Water ski, wake board, Knee board, Trampoline, inflatable Kayaks and snorkeling gear

Jacuzzi

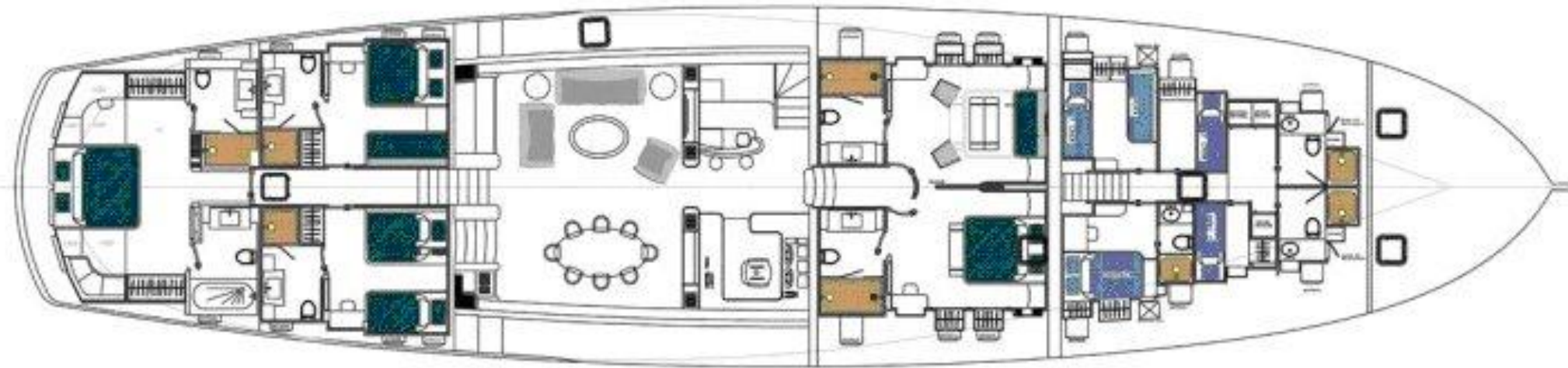

Prices include:

- An average of 4 hours per motor cruising per day over the duration of the cruise
- Welcome briefing, crew introduction, and itinerary/weather review
- Turkish port and harbor formalities in municipal ports
- Hire of crew, yacht, fuel, water, insurance, and local taxes
- Yacht laundry
- Use of yacht toys (water sports, snorkeling, fins, canoe, fishing equipment)

Prices do not include:

- Airport transfers (except for all-inclusive charters)
- Full board and drinks (except for all-inclusive yachts)
- Land excursions and museum entry fees
- Greek island customs, port and harbor fees
- Fuel for additional distances in excess of 4 hours per day
- Fuel for on-board toys
- Cancellation insurance
- Private Turkish marina fees
- Spirits, import wines and specialty drinks. These can be brought on board by client, or ordered in advance.
- Water sports (3rd party water skiing, jet skiing, scuba diving)
- Fuel for on-board toys
- Crew gratuity